

**Report on Piping Phenomenon in front of the house of Mr. V.K
Balan, S/O Kottan (L), Nellyadukkam, Kollampara,
Neeleswaram, Kasargode**

Ref: Government Ltr. No. 68141/K2/2014/DMD dated 16-06-2016



Investigation Series 2016
22-08-2016

State Emergency Operations Centre
Kerala State Disaster Management Authority
Department of Revenue and Disaster Management, Govt. of Kerala
2nd Floor, Institute of Land and Disaster Management
PTP Nagar, Thiruvananthapuram 695038
Tel/Fax: 0471-2364424. Email: seoc.gok@gmail.com



Underground caves are seen, formed at 3 locations causing serious threat to the area highlighting the presence of soil pipes. The underground caves are bedded with a thin layer of granite. The caves which had formed underground are about 5 to 6 meter wide in the same direction and are interconnected.

The plantation type of the area is rubber and soil type is laterite. No such incidents have reported before, nearby houses and wells are all in good condition.

On 2nd August 2014 during heavy rains, land below the house of Mr. Balan which was under construction and had reached upto lintel level, caved in triggering a landslip (landslide). Consequent to this, the Executive Engineer (I/C), PWD Buildings Division, Kasargode intimated that the site is unsuitable for construction and accordingly the building was dismantled.

Based on the site visit and the facts ascertained, it is concluded that the land is not stable structurally and geologically. Thus the land is not safe and suitable for further building or construction purpose. Illustrations and photographs of site inspection are included herewith.

Recommendation

1. Government may consider allotting Mr. V.K Balan, S/O Kottan (L), Nellyadukkam, Kollampara, Neeleswaram, Kasargode the maximum relief assistance payable under SDRF & CMDRF (₹2,00,000/-) for house damage due to landslip (landslide). Subsequently, the matter may be placed before the State Executive Committee of KSDMA for ratification in accordance with GO (Rt) No. 2167/2016/DMD dated 19-03-2016.

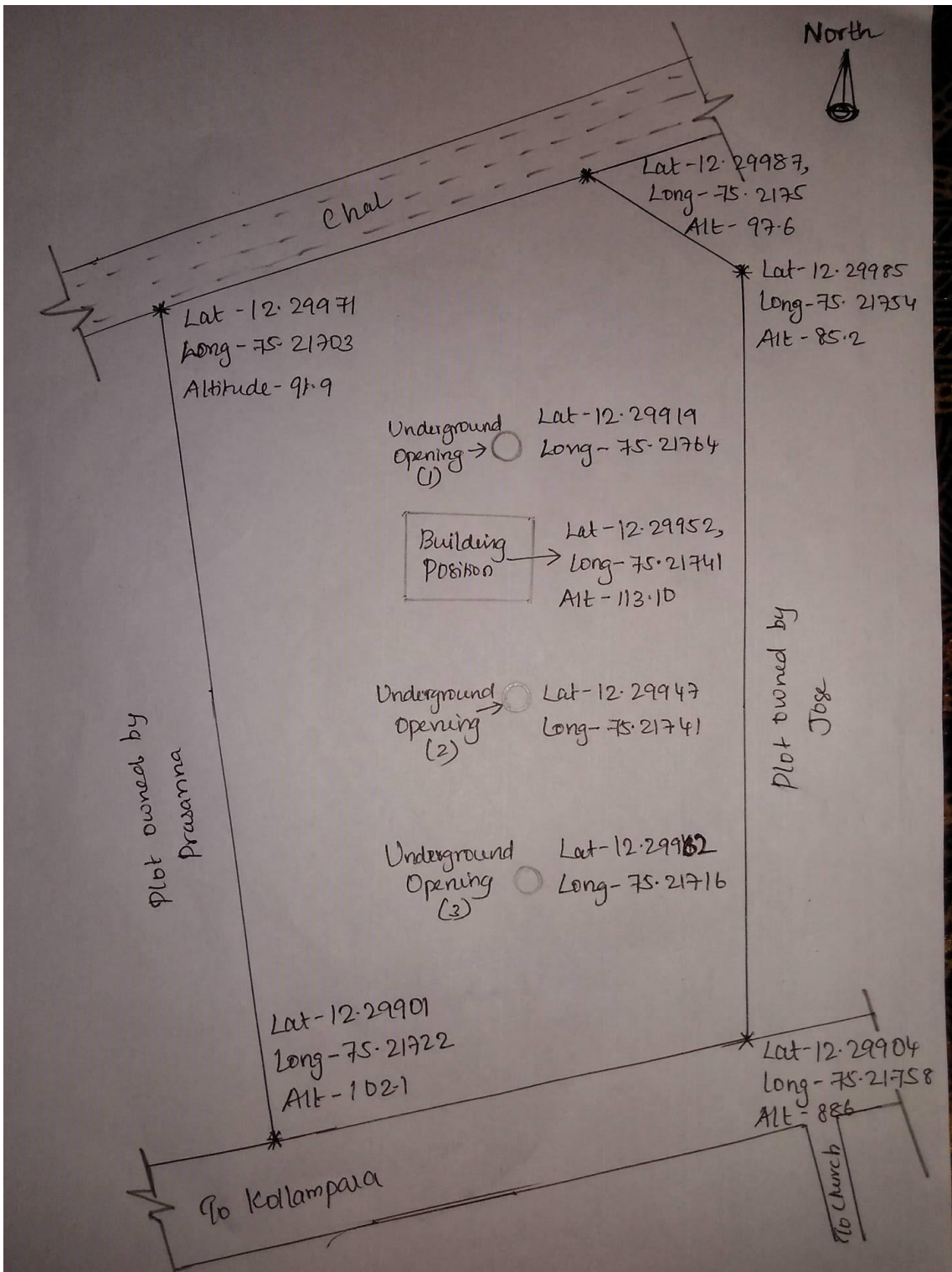

Fig 1: Area layout

Building Location



Underground Caves







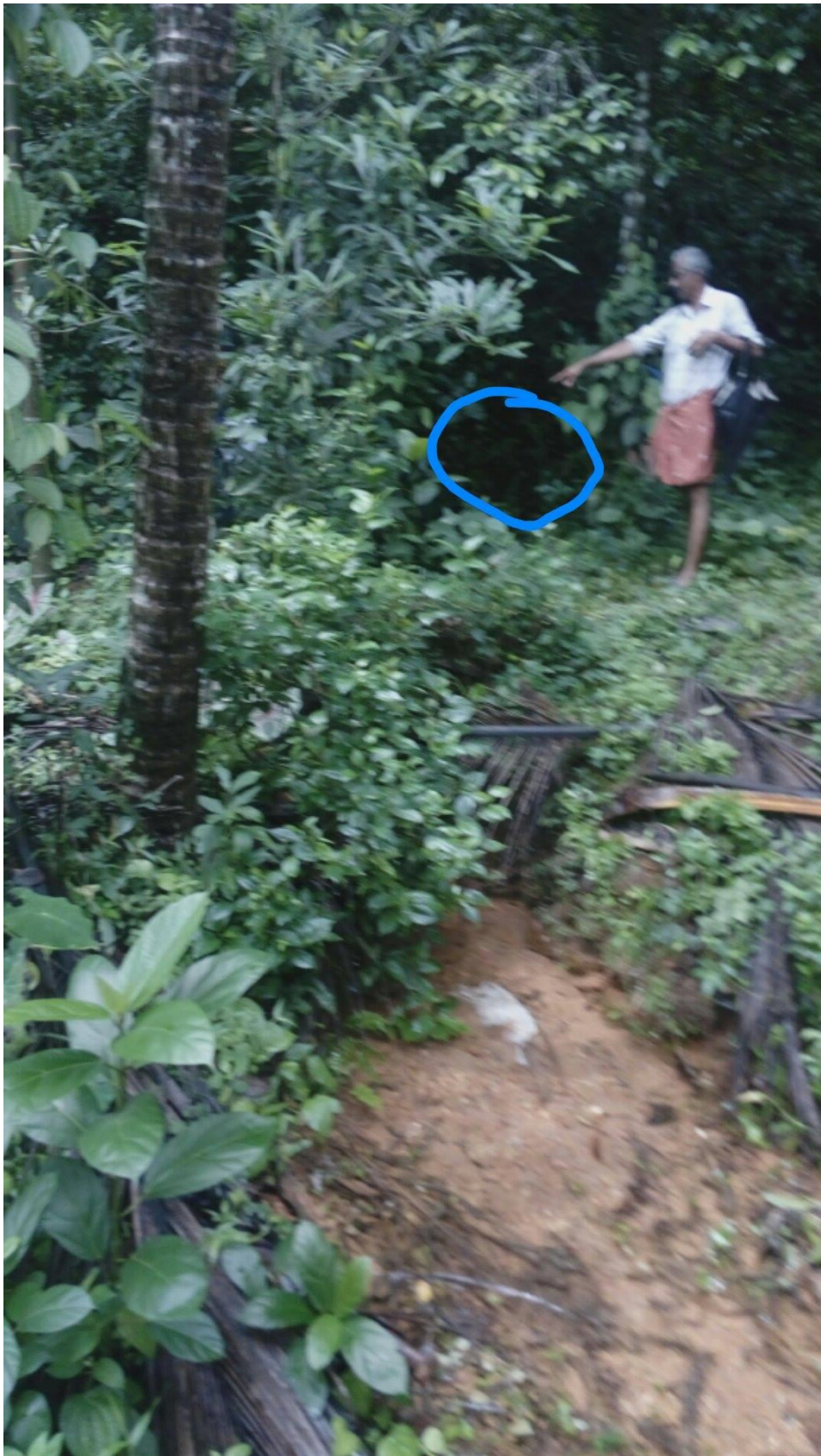



Chalu



Kollampara Road

